

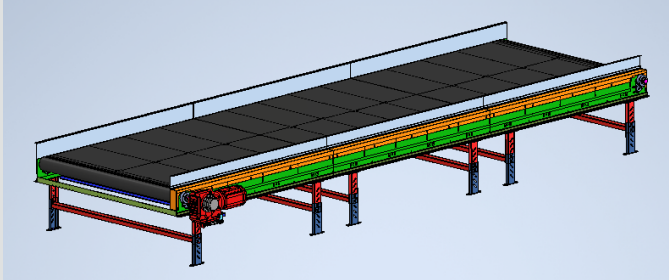

The Next Generation of Turns

SLBP Merge Table Design Details

SLBP1 Merge Table for Unidirectional Merge Operation



SLBP Design Features

- Proven SLB Loose Belt Technology
- Chain attached to the belt on either one side (SLBP1) or both sides (SLBP2), allowing single or double chain drive for unidirectional or bidirectional merge operation
- Reinforced Framework, built in sections
- Heavy-duty Support Structure
- Configurable with many options

Drive Arrangement Options

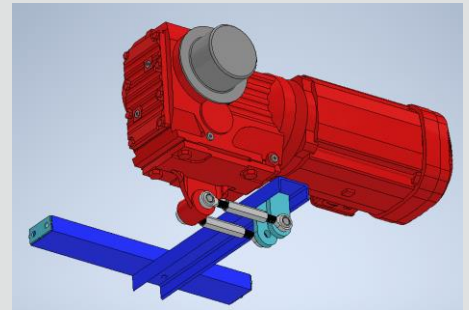

Drives can be shaft-mounted or underslung on either side of the discharge end.

Shaft-mounted drives can be arranged horizontally (shown) or vertically, depending on available space.

SLBP2 Merge Table for Bidirectional Merge Operation

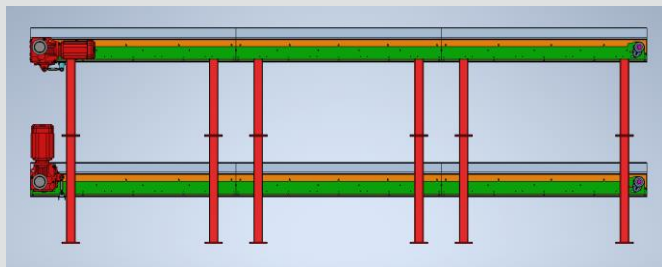
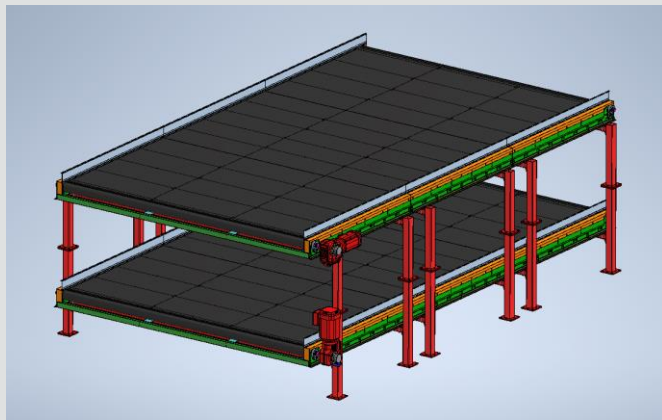

Shown are two (2) stacked SLBP2 Merge Tables

SLBP2 Drive Pulley Detail

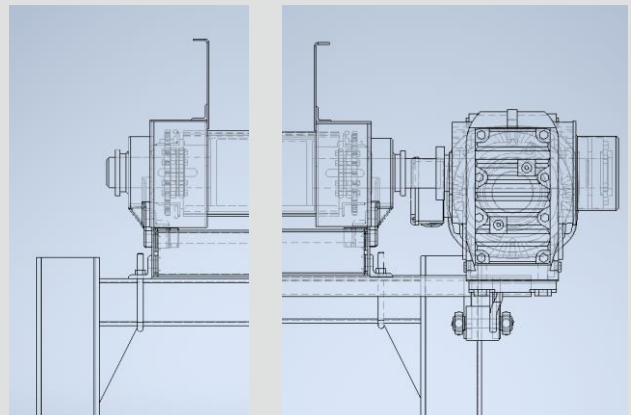

SLBP2 Drive Pulley with Sprocket on both ends

© FLOW-TURN Inc. 2024, subject to modification



1050 Commerce Avenue, Union, NJ 07083

Phone: (908) 687 – 3225
Fax: (908) 687 – 1715
Email: sales@flow-turn.com
www.flow-turn.com

*Custom design is a FLOW-TURN specialty.
We manufacture to rigid specifications and provide answers to unusual requirements.*

**SLBP1-LH-LO Merge
with one (1) Plow
for Unidirectional
Merge Operation**

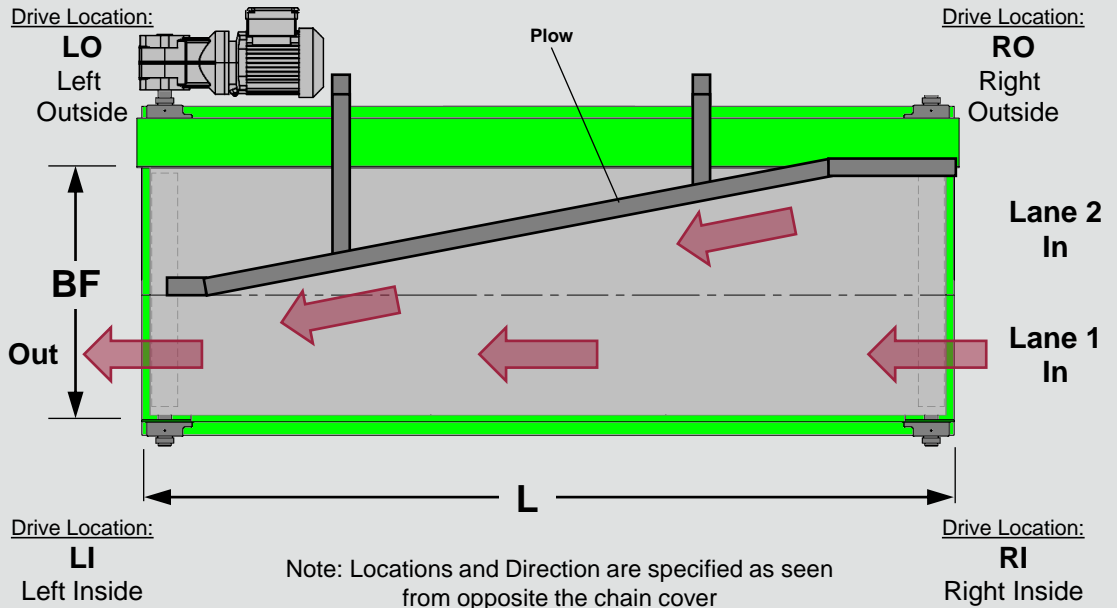

Flow-Turn Model Code

SLBP1-60_96-P4.0-LH-LO

Identifier **SLBP1** or **SLBP2**

BF Between Frame

L Conveyor Length

"P" and End Roll ("Puck") Diameter

Direction of Travel (**LH** or **RH**)

Drive Location (**LI**, **LO**, **RI** or **RO**)



SLBP1 Merge
Table with Plow
(Model SLBP1-93-180-P5.0-RH-RI)



SLBP1 Merge Table used as sorter discharge
conveyor (Model SLBP1-72_210-P5.0-RH-RO)